

OPITEC

Oldtimer
101.129

ATTENTION!

Cet article contient des petites pièces
qui peuvent être avalées.
Attention, risque d'étouffement!

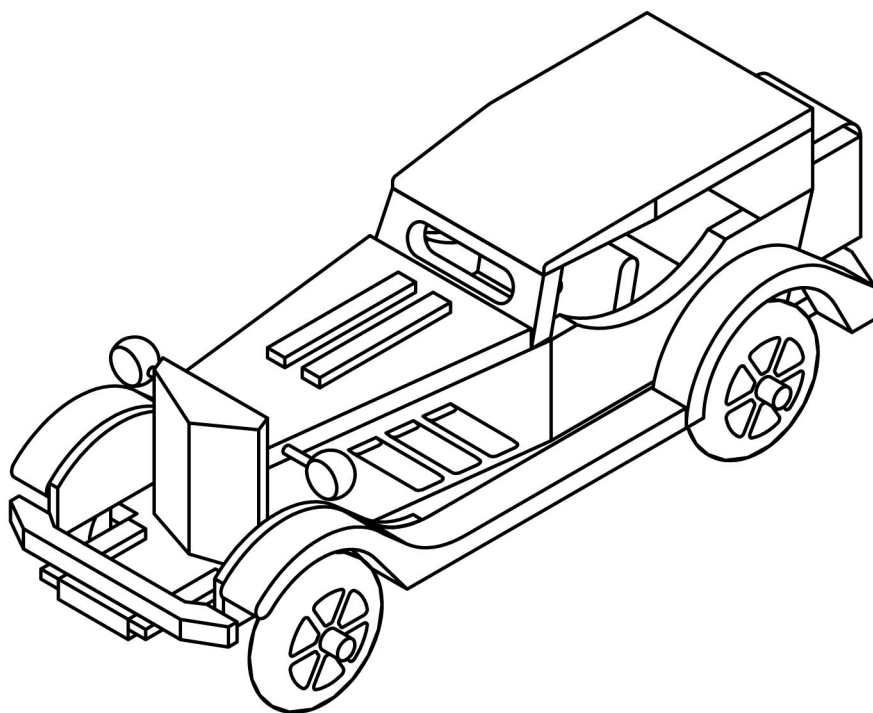
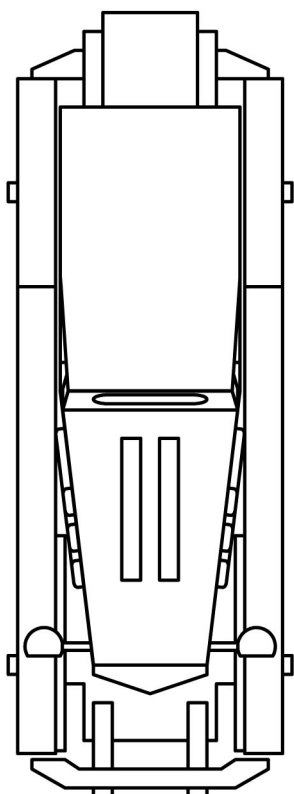
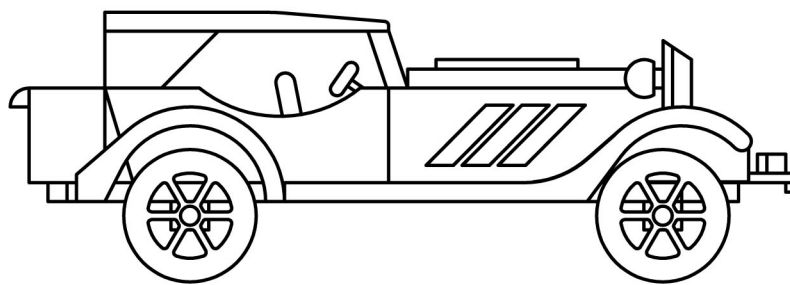
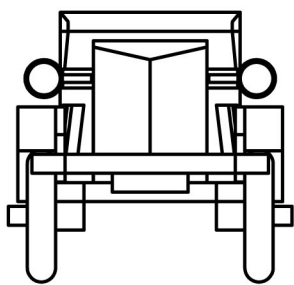

REMARQUE

Une fois terminées, les maquettes de construction d'OPITEC ne sauraient être considérées comme des jouets au sens commercial du terme. Ce sont, en fait, des moyens didactiques propres à accompagner un travail pédagogique. Ce kit de construction ne doit être construit et utilisé par les enfants et les jeunes adolescents QUE sous la direction et la surveillance d'adultes expérimentés. Ne convient pas aux enfants de moins de 36 mois. Risque d'étouffement!

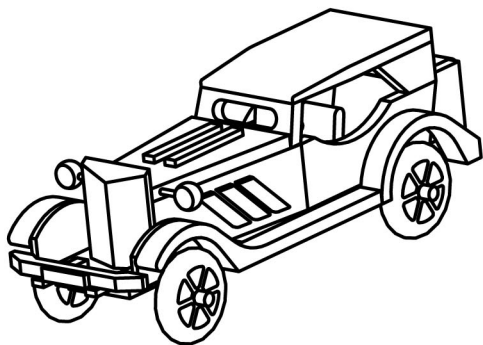

Oldtimer
101.129

ORITEC
Hobbyfix

1	1	Plaque de fond	10 x 100 x 350
2	2	Parois latérales	10 x 50 x 300
3	2	Parois latérales du capot	10 x 50 x 150
4	1	Capot	10 x 100 x 150
5	1	Paroi arrière	10 x 60 x 75
6	1	Siège a) Dossier	10 x 60 x 75
	1	b) Siège	10 x 40 x 75
7	1	Radiateur	15 x 60 x 75
8	1	Tableau de bord	5 x 15 x 75
9	1	Axe du volant (support des phares)	Ø 4 x 100
10	1	VolantRoue	Ø 20
11	2	Phares a) Support	Reste de Ø 4 x 100
	2	b) Phares	Boule Ø 20
12	1	Pare-brise	10 x 40 x 100
13	1	Vitres latérales	10 x 30 x 100
14	1	Vitre arrière	10 x 30 x 75
15	1	Toit	10 x 100 x 150
16	2	Ailes avant	20 x 50 x 250
17	1	Ailes arrière	20 x 50 x 250
18	1	Couvre-roue	5 x 40 x 250
19	1	Aération capot	5 x 10 x 150
20	1	Pare-chocs avant a) Support & plaque d'immatriculation	5 x 10 x 150
	1	b) Pare-chocs	10 x 15 x 125
21	1	Pare-chocs arrière	10 x 15 x 125
22	2	Pot d'échappement	5 x 10 x 150
23	1	Coffre a) Socle	10 x 40 x 50
	2	b) Parois latérales	10 x 40 x 50
	2	c) Paroi avant & arrière	10 x 30 x 50
	1	d) Couvercle	10 x 50 x 50
	2	e) Clous en acier	15
24	4	Roues a) Roues à rayons	Ø 70, Ø 7
	1	b) Support	Ø 10 x 50
	1	c) Essieux	Ø 6 x 150
	1	d) Fixation des essieux	15 x 15 x 100

L'épaisseur du matériel est à chaque fois indiquée dans le plan avec un « t » (par ex.: t= 10, pour une épaisseur de 10 mm.)

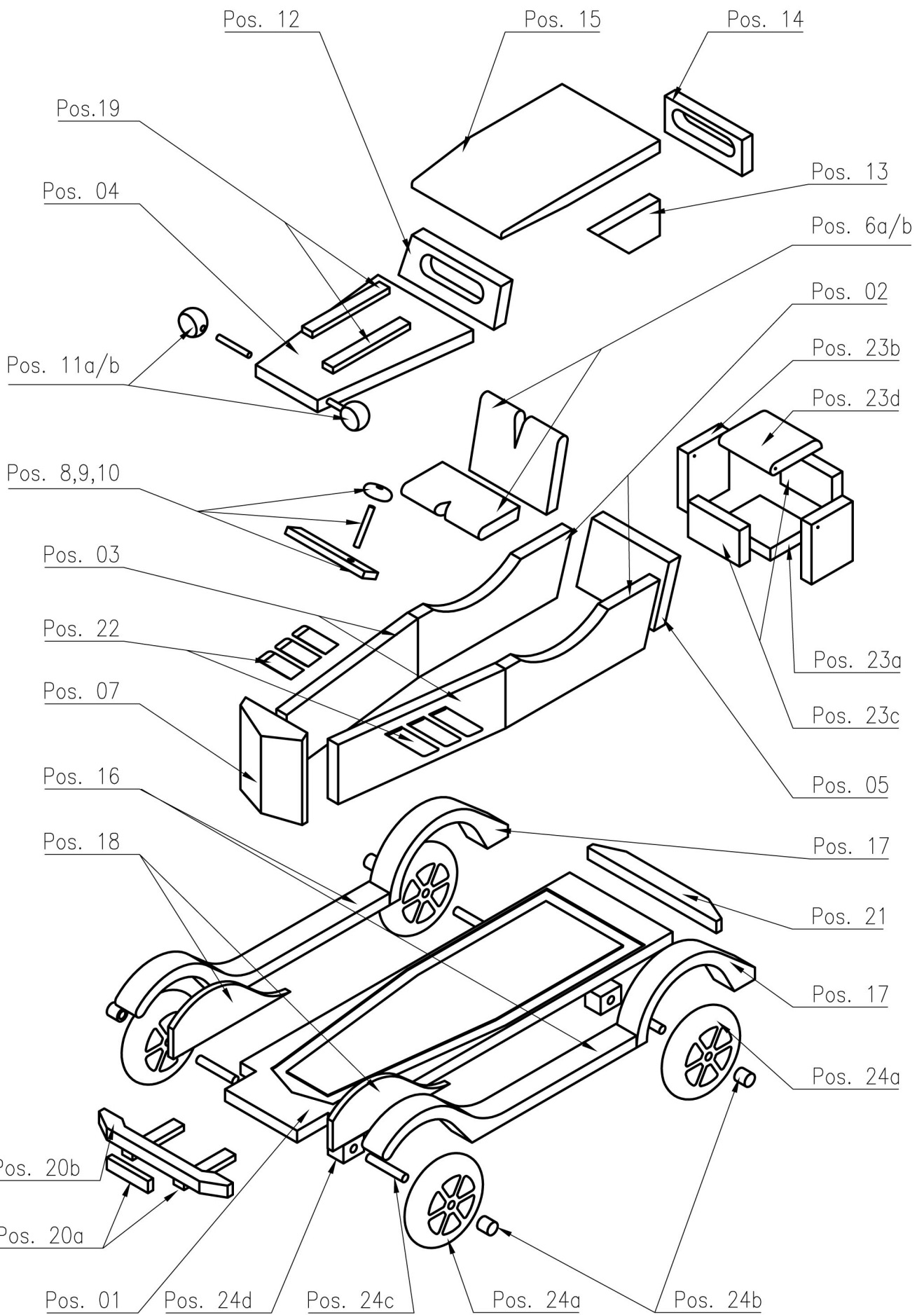

1. Plaque de fond

Scier les évidements
Marquer les zones à coller sur la plaque de fond.

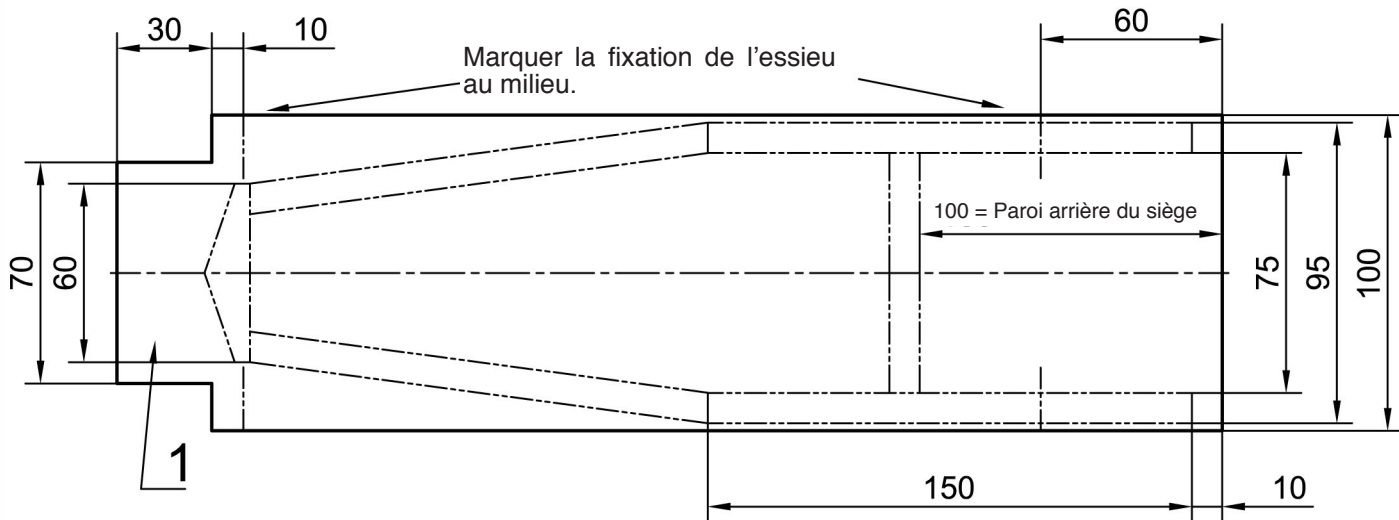
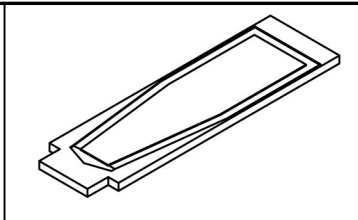

2. Parois latérales du capot, pot d'échappement

Limer les arêtes des parois latérales.
Scier les tubes du pot d'échappement et travailler à la lime

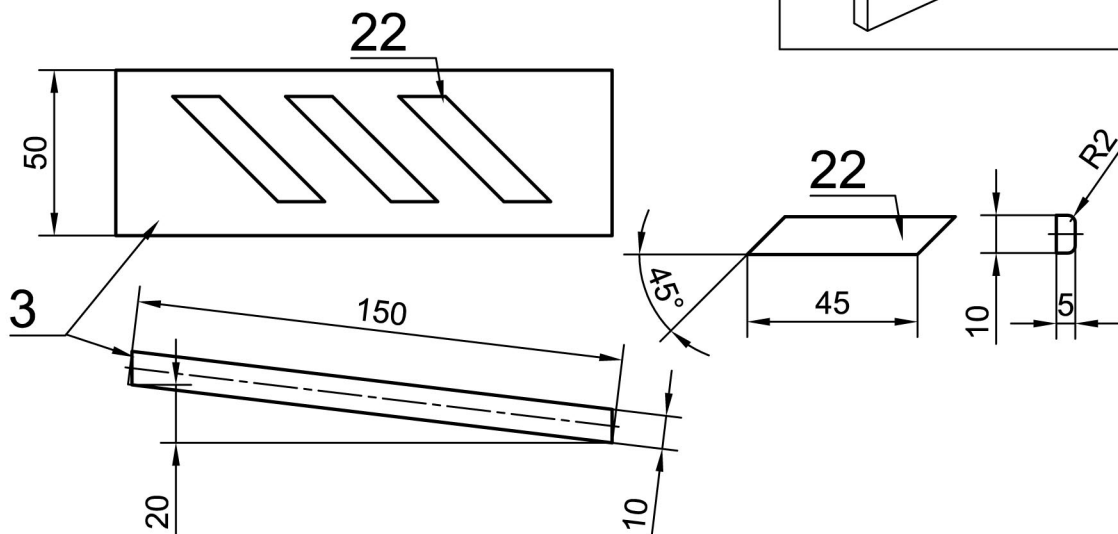
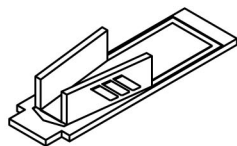
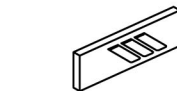
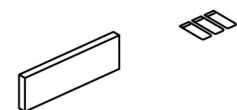
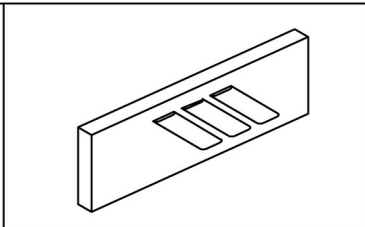

3. Parois latérales avec arrondi

Arête du tableau de bord (T 8) sur l'arête de la paroi latérale

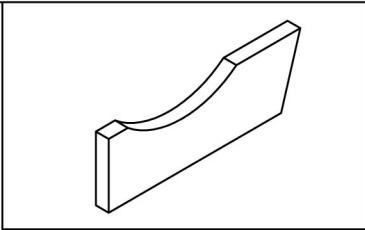

Choisir l'arrondi selon votre gré

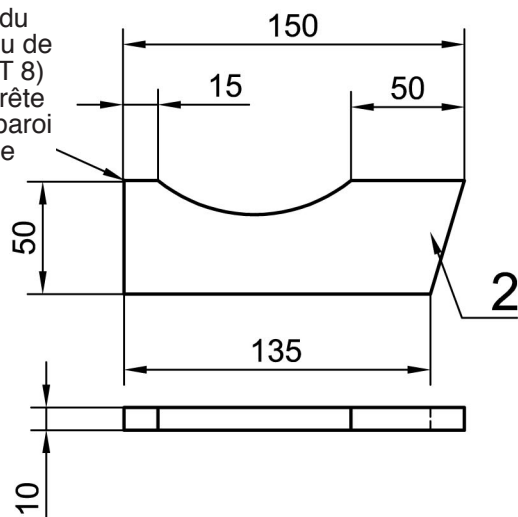
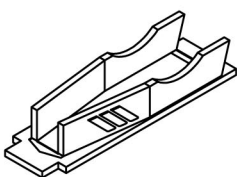
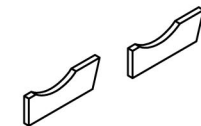

Nr.:	1
------	---

Oldtimer
101.129

OPITEC
Hobbyfix

D101129#1

4. Radiateur

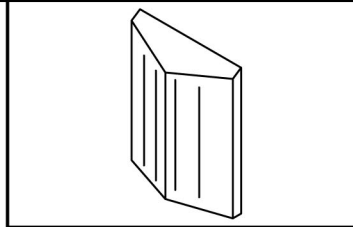
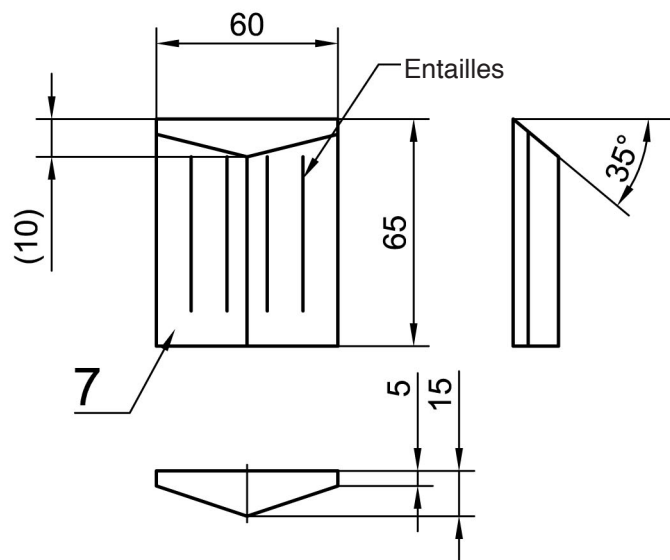

Lime le radiateur à env. 35°.

Fais encore d'autres entailles sur la paroi avant

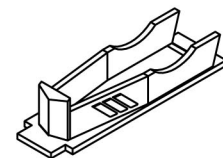
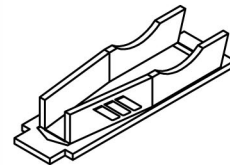

5. Paroi arrière

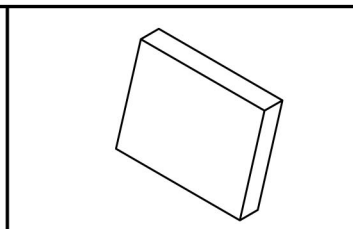
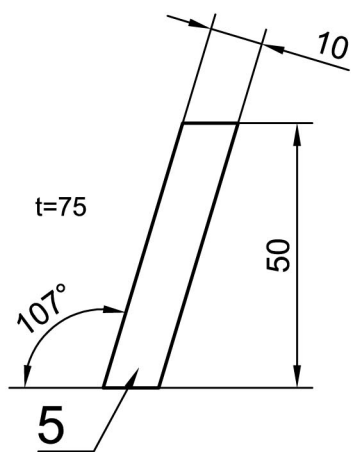

Prendre les dimensions à partir du dessin.

Travailler l'inclinaison avec la lime.

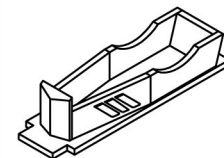

6. Siège

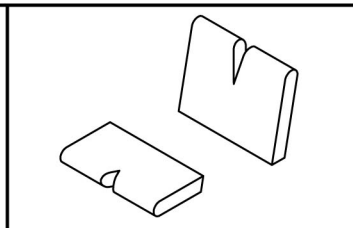
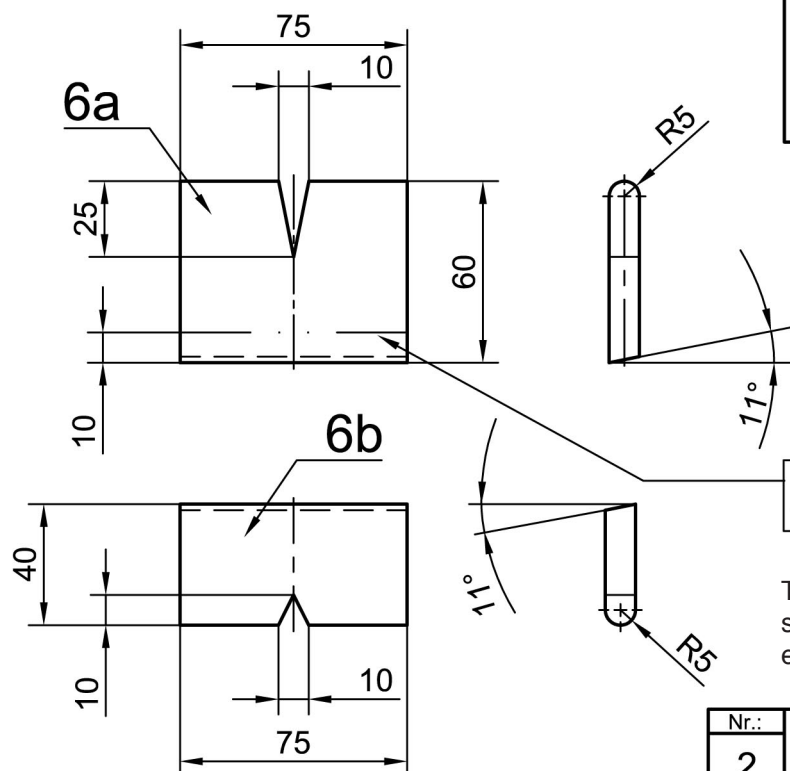

Mettre l'arête inférieure du siège sur la ligne

Travailler le dossier et le siège avec la scie et la lime et coller.

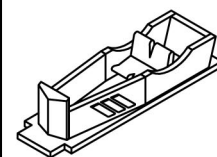

Nr.:	
	2

Oldtimer
101.129

OPITEC
Hobbyfix

7. Capot

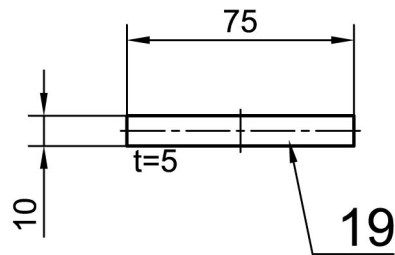
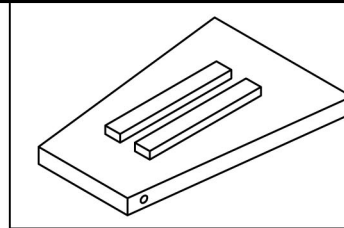
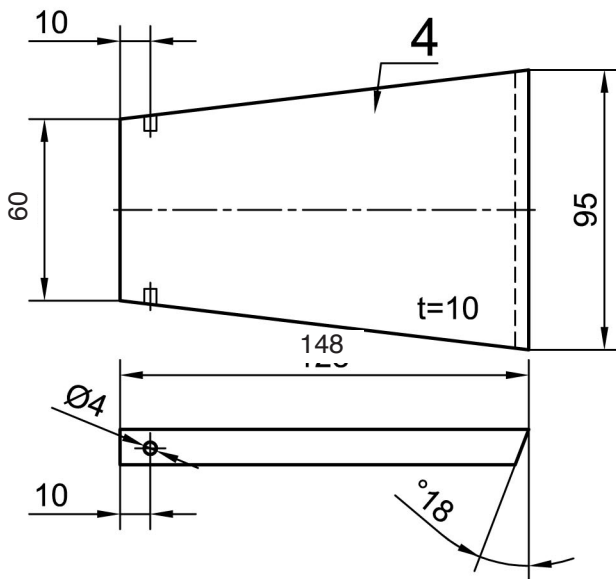

Perce deux trous borgnes de 4 \varnothing x 10 pour le support des phares.

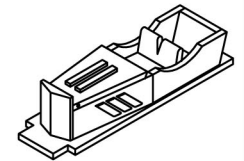
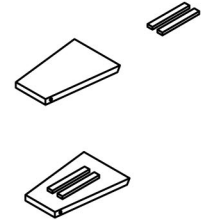
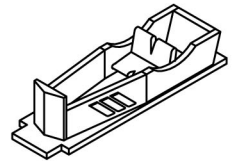

8. Pare-brise

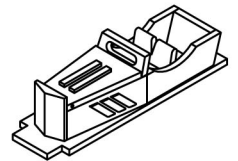
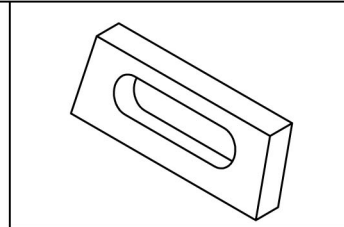
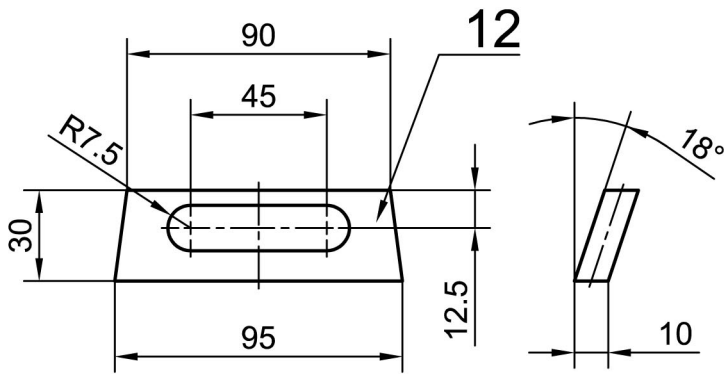

9. Vitre arrière

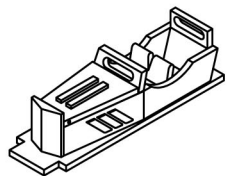
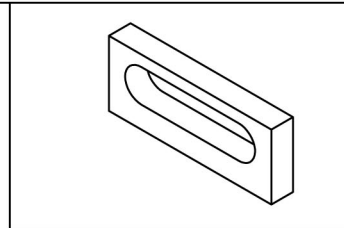
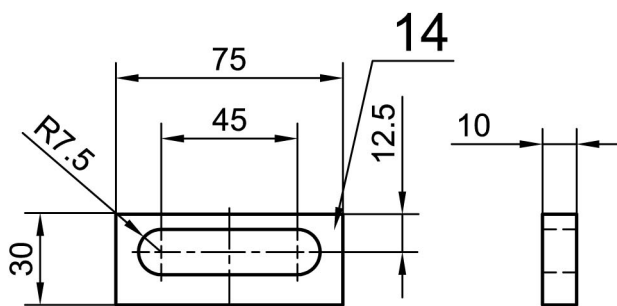

10. Vitres latérales

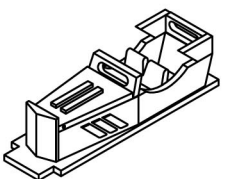
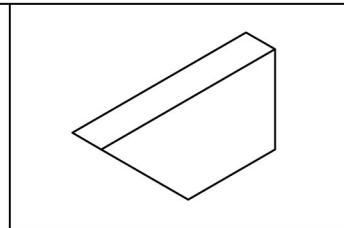
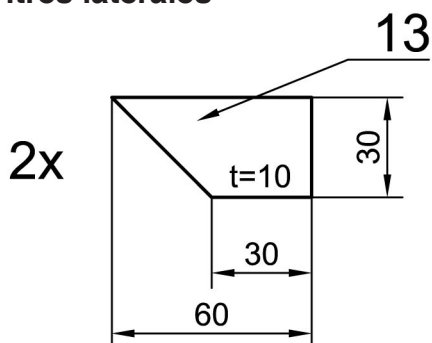

Nr.:	3
------	---

Oldtimer
101.129

ORITEC
Hobbyfix

D101129#1

11. Tableau de bord

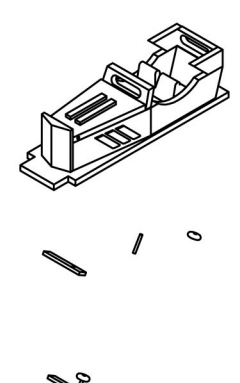
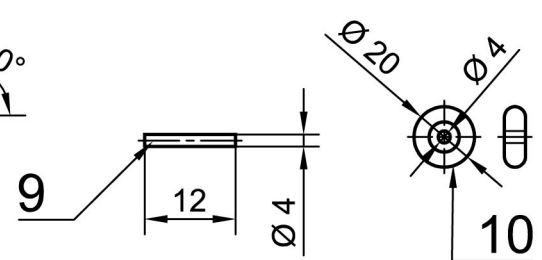
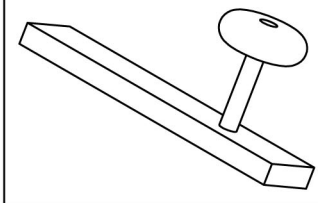
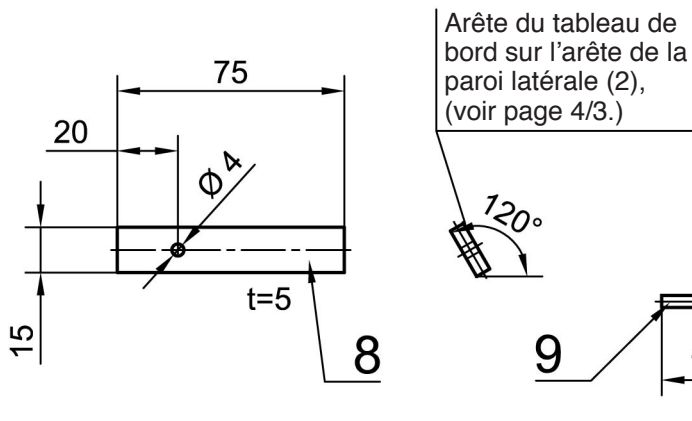

12. Toit

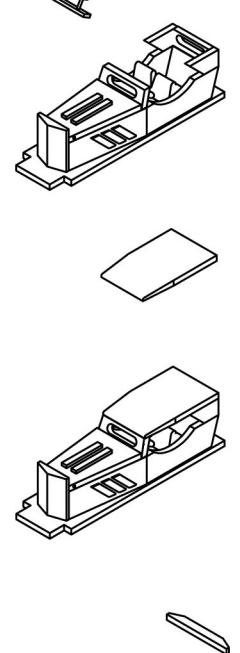
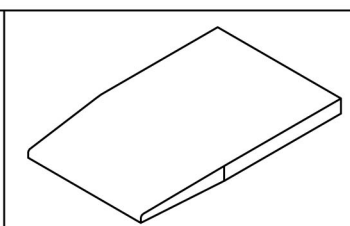
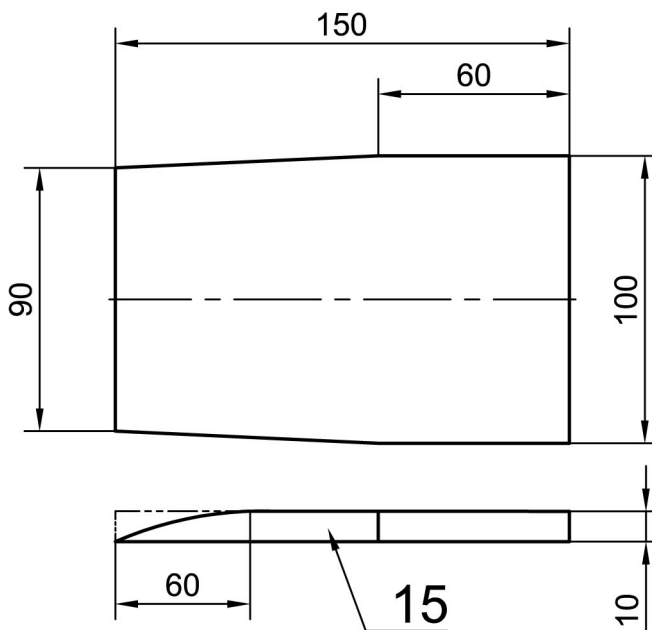

13. Pare-chocs arrière

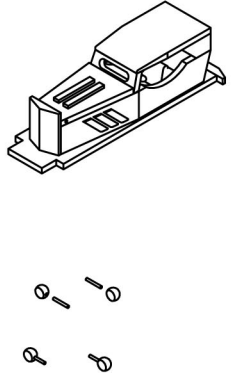
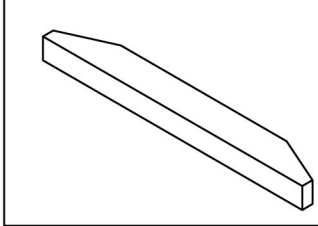
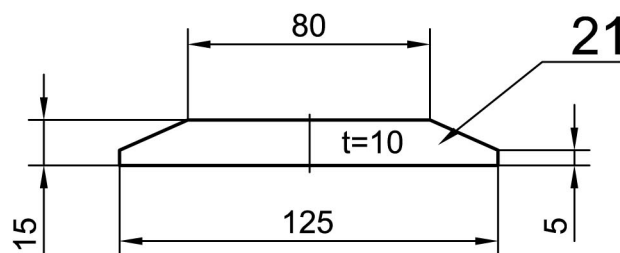

14. Phares et support

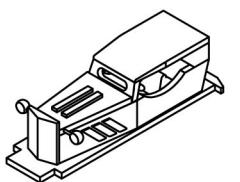
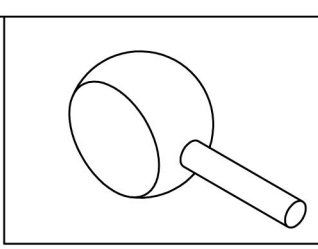
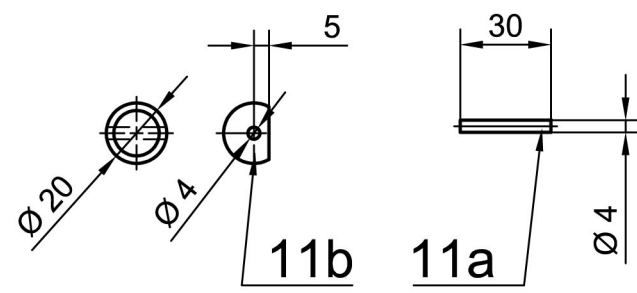

Nr.:	
4	

Oldtimer

ORITEC
Lichtfix

15. Coffre

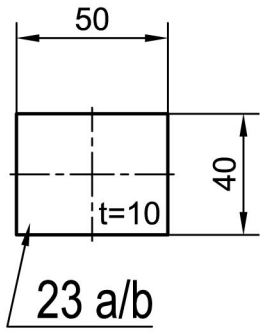

3x

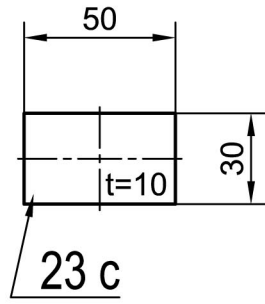

2x

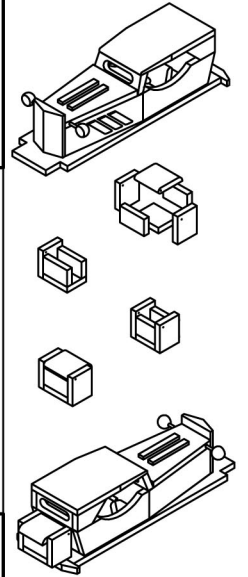
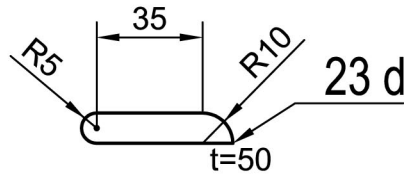
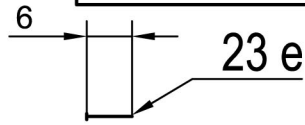
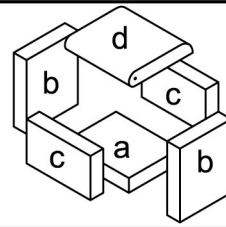

16. Pare-chocs avant

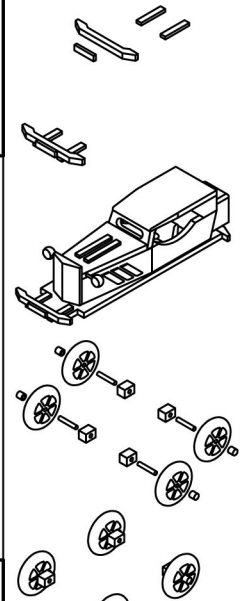
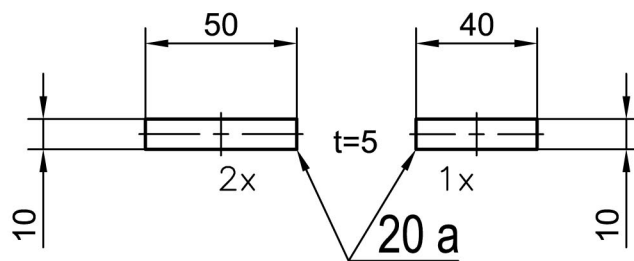
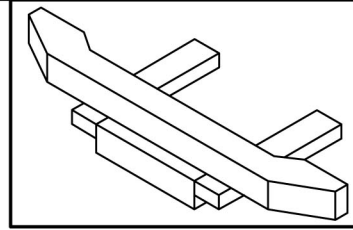
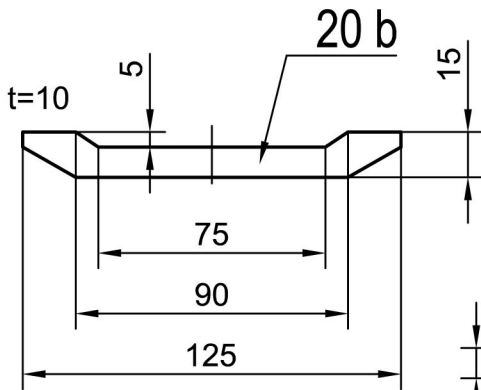

17. Roues, Essieux, Supports

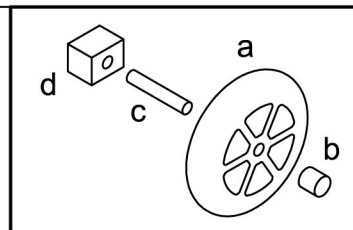
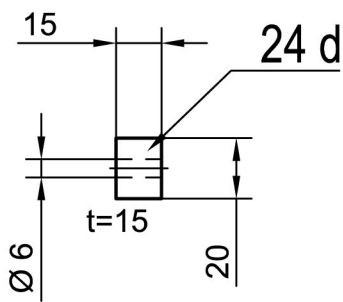

je 4x

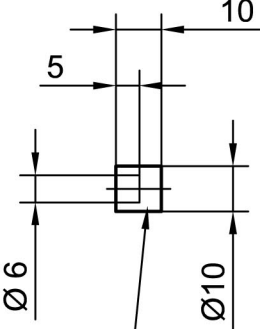

24 b

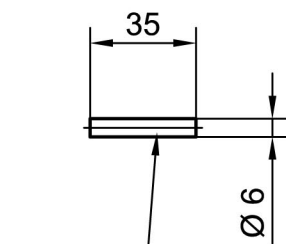

24 c

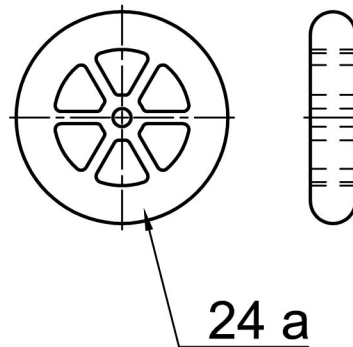

24 a

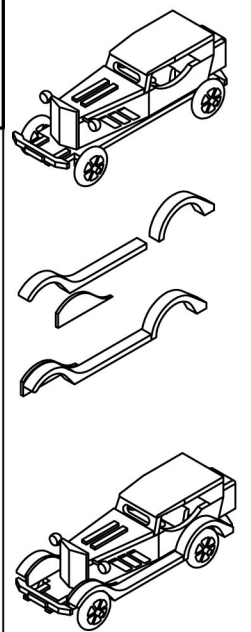

Nr.:	5
------	---

Oldtimer
101.129

OPITEC
Hobbyfix

Pochoirs pour les ailes avant et arrière et pour les couvre-roues

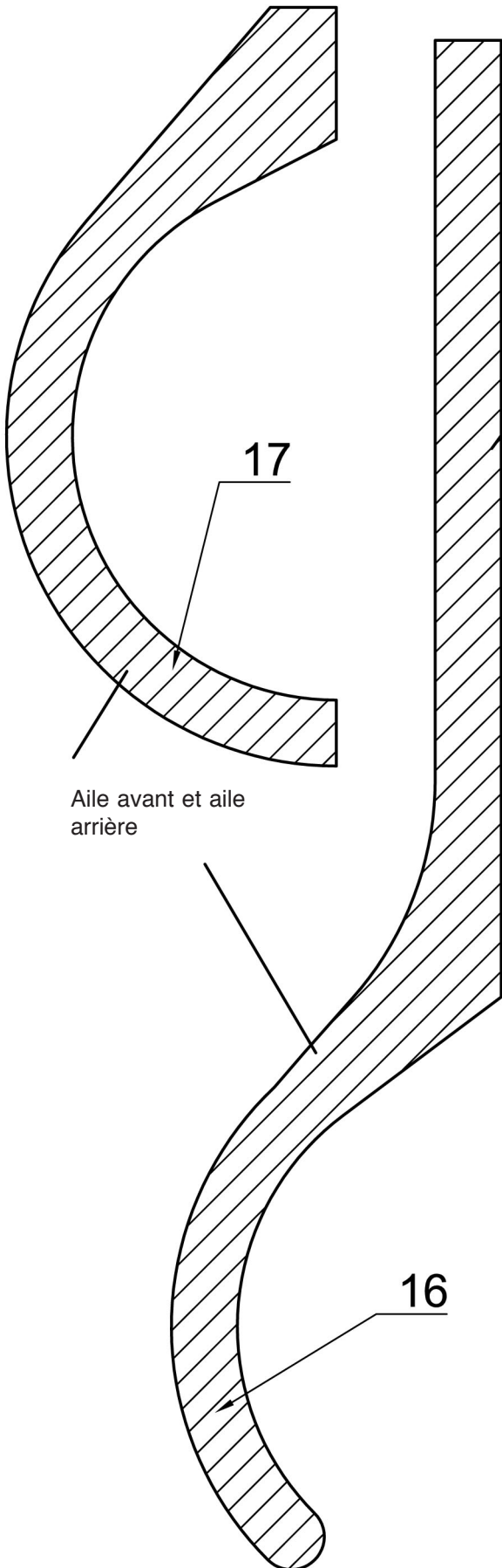
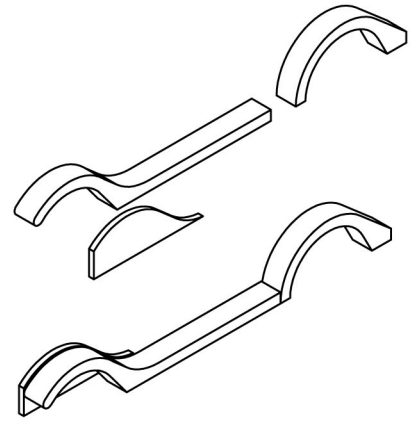

17

Aile avant et aile arrière

16

Reporter 2 fois le pochoir pour les ailes sur les lattes 20 x 50 x 250 mm et scier

Reporter 2 fois le pochoir des couvre-roues sur la latte 5 x 40 x 250 mm et scier

Avant de scier, comparer les contours avec les ailes avant et corriger le cas échéant.

18

Couvre-roue

Nr.:	Oldtimer	OPITEC
6	101.129	Hobbyfix