

# Concrete Etagere



## 1. Etagere

Material Used	Article Number	Quantity
Metal Etagere Construction Kit Classic, approx. 330 mm, handle approx. $\varnothing$ 45 x 5 mm, silver coloured, 9 parts	554738	1
Casting Mould - Etagere Round, approx. $\varnothing$ 130 mm, $\varnothing$ 158 mm, $\varnothing$ 250 mm, approx. 10 mm high material required: approx. 1400 g jewellery-cement, set of 3	567928	1
Fine Concrete for Jewellery, 3000 g	608806	as required
Release Agent - Formestone 100 ml	480666	1
Stencil - Dots approx. 210 x 297 mm	574732	1
Marabu Stencil Adhesive Spray 36 ml	483642	1
Metal - Decorative Ribbon, approx. 3 m x 30 mm, mint green	948513	1
Silver Wire, approx. $\varnothing$ 0,40 mm, 40 m	249115	1
PintyPlus® Chalk Finish Spray Paint, 400 ml, light turquoise	609879	1
Liquitex Spray 400 ml, neutral grey	483446	1
Beech Dowel, approx. $\varnothing$ 8 mm x 50 cm, pack of 10	681062	1
Half Ball Buttons - Beech, 10 pieces approx. $\varnothing$ 30 mm	109335	1
Wooden Balls with Hole, approx. $\varnothing$ 35 mm, hole approx. 8 mm, pack of 5	601952	1
Wooden Balls with Hole, approx. $\varnothing$ 45 mm, hole approx. 8 mm, pack of 3	602006	1
<b>Recommended Tools</b>		
BOSCH Glue Gun PKP-18E Electronic	301128	1
Glue Sticks, approx. $\varnothing$ 11 x 200 mm, 25 pieces	301139	1
<b>Tools Required</b>		
Working pad, paper, pen, compass, ruler, scissors, kitchen roll, plastic wrap, brush, vegetable oil, measuring cup (or scales), mixing bowl, whisk (or spatula), winding wire side cutter, knife, hot glue gun and glue sticks, handsaw, drilling machine with $\varnothing$ 8 mm wood drill.		

## Basic Instruction Concrete

1. Apply release agent to the inner surface of the casting mould.

The release agent depends on the mould material:

Release agent Formestone is used for moulds from plastic, latex and silicone.

Formalate Latex Casting Compound is used to cure paper art models and paper moulds for concrete casting. Generously apply Formalate to the interior surfaces of the cardboard and paper models and allow to dry. Handle both release agents according to product instruction.

2. Mix creative or fine concrete with water according to product description.

3. Fill casting mould with concrete.

4. Allow to dry for approx. 1 - 2 days. Drying time depends on model size.

5. Remove casting mould, allow residual moisture to escape.

6. Now you can paint and decorate the model according to the design or as you like.

## Instruction 1. Etagere

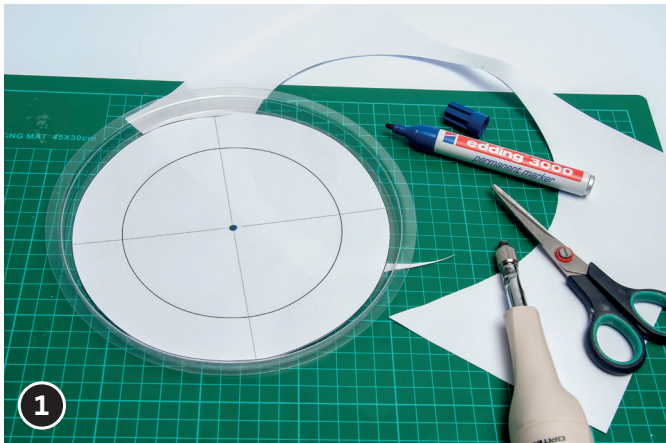

Determine the center of the three casting moulds with paper and compass.

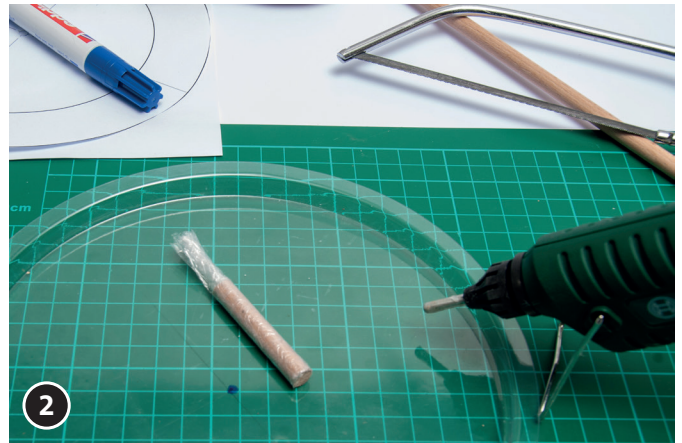

With the handsaw cut from an approx.  $\varnothing$  8 mm beech dowel three approx. 5 cm long parts. Another dowel cut to 35 cm (will be needed later). Wrap plastic wrap around the small dowels.

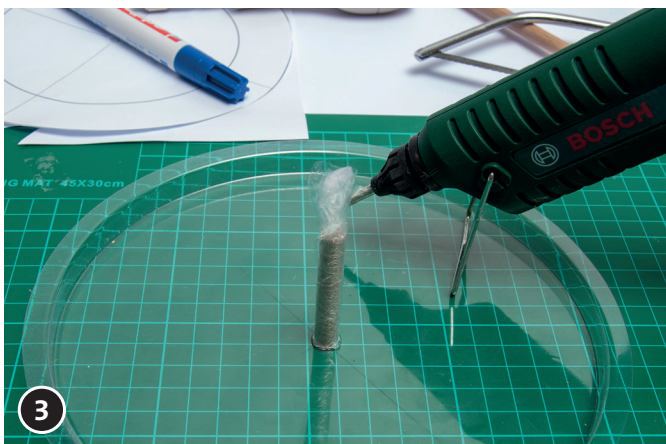

Fix the small dowels in the center with the glue gun.

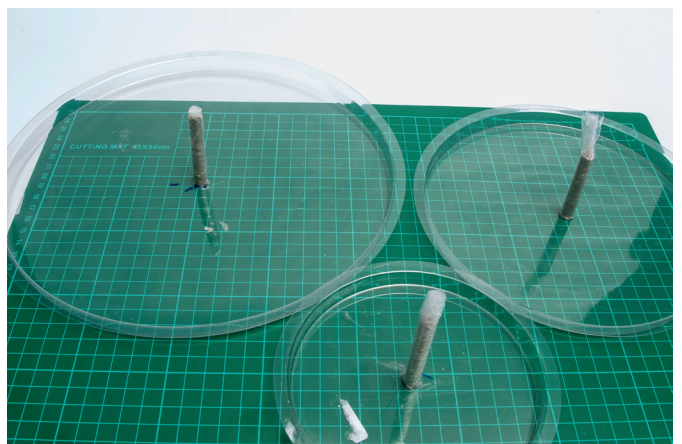

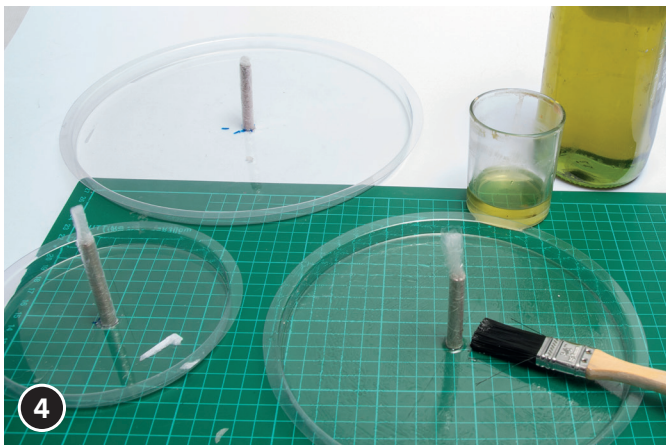

4 Apply release agent Formestone (or vegetable oil) generously to casting moulds and wooden sticks.



5 Cast concrete according to basic instruction. Remove dowels after drying.



6 With the wood drill bore holes  $\varnothing$  8 mm again into the wooden balls and half ball buttons.



7 Thread wooden balls and half ball buttons onto a dowel and prime with Liquitex Spray neutral grey. ( $\varnothing$  35 mm = 4 pieces,  $\varnothing$  45 mm = 2 pieces, half ball buttons  $\varnothing$  30 mm = 9 pieces). Also paint the approx. 35 cm dowel you have prepared before. Allow paint application to dry.



8 Spray the stencil backside with adhesive spray and let dry.

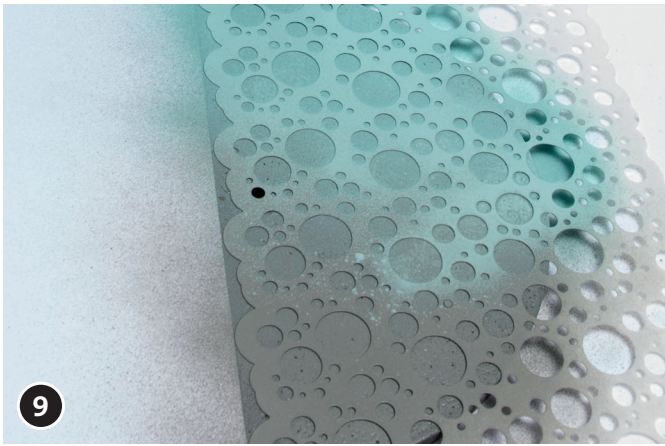

Place the stencil upon the concrete plate with the backside facing down. Spray with PintyPlus® Chalk Spray light turquoise, remove stencil and allow the paint application to dry.



With the side cutter cut the metal decorative ribbon to size according to the relating circumference of the three concrete plates. Place the metal ribbon around the concrete plate and fix with the hot glue gun. Connect the two ribbon ends with silver wire.

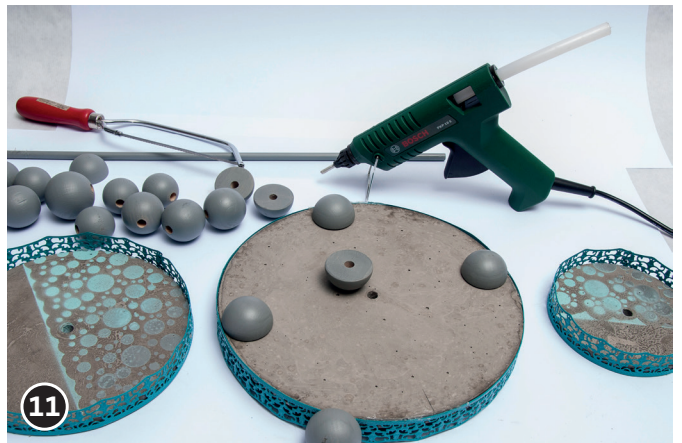

With the glue gun also fix the four half ball buttons without hole to the lower side of the large concrete plate.



Attach a half ball button and the 35 cm dowel to the upper side of the concrete plate. Then thread a small, a large, a small ball and another half ball button. Glue the second concrete plate to the dowel with the balls.

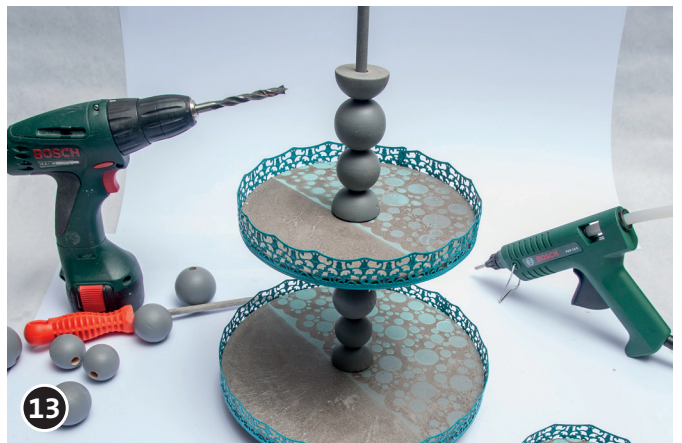

Now thread a small and a large ball and then another half ball button. Glue the third concrete plate. At the top of the dowel fix the last small ball.

## 2. Etagere



Material Used	Article Number	Quantity
Metal Etagere Construction Kit Classic, approx. 330 mm, handle approx. $\varnothing$ 45 x 5 mm, silver coloured, 9 parts	554738	1
Casting Mould - Etagere Round, approx. $\varnothing$ 130 mm, $\varnothing$ 190 mm, $\varnothing$ 250 mm, approx. 10 mm high material required: approx. 1400 g jewellery-cement, set of 3	567928	1
Fine Concrete for Jewellery, 3000 g	608806	as required
Release Agent - Formestone 100 ml	480666	1
Stencil - Baroque, approx. 150 x 150 mm	501067	1
Marabu Stencil Adhesive Spray 36 ml	483642	1
PintyPlus® Chalk Finish Spray Paint, 400 ml, black	609938	1
Metal - Decorative Ribbon, approx. 3 m x 30 mm, mint green	948524	1
Silver Wire, approx. $\varnothing$ 0,40 mm, 40 m	249115	1
Recommended Tools		
BOSCH Glue Gun PKP-18E Electronic	301128	1
Glue Sticks, approx. $\varnothing$ 11 x 200 mm, 25 pieces	301139	1
Tools Required		
Working pad, paper, pen, compass, ruler, scissors, kitchen roll, plastic wrap, vegetable oil, brush, measuring cup (or scales), mixing bowl, whisk (or spatula), winding wire, side cutter, knife, hot glue gun and glue sticks		

## **Basic Instruction Concrete**

1. Apply release agent to the inner surface of the casting mould.

The release agent depends on the mould material:

Release agent Formestone is used for moulds from plastic, latex and silicone.

Formalate Latex Casting Compound is used to cure paper art models and paper moulds for concrete casting. Generously apply Formalate to the interior surfaces of the cardboard and paper models and allow to dry. Handle both release agents according to product instruction.

2. Mix creative or fine concrete with water according to product description.

3. Fill casting mould with concrete.

4. Allow to dry for approx. 1 - 2 days. Drying time depends on model size.

5. Remove casting mould, allow residual moisture to escape.

6. Now you can paint and decorate the model according to the design or as you like.

## **Instruction 2. Etagere**

1. Cast concrete into the casting mould as described in the description above.

2. Don't fill the mould with concrete than up to 1 cm, otherwise the thread of the construction kit does not engage. The thread of the etagere kit, which has to be lead through the bore hole is of  $\varnothing 5 \times 10$  mm.

The threaded plate on which the concrete plate will be placed later, is of  $\varnothing 15$  mm.

3. Into the center of the casting mould place an approx. 8 mm thick dowel (as a place holder) for the boring (for the thread).

4. As described earlier wrap plastic wrap around this dowel and fix in the center of the casting mould with the hot glue gun.

5. Finish concrete plates and paint. Decorate with stencil and PintyPlus® Chalk Spray black. Screw on the finished plates to the parts of the etagere construction kit.

6. This means lead the metal thread of the etagere kit through the boring of the concrete plate and screw on to the next metal part.

7. In case that a concrete plate has turned out a little thick, you can carve the backside of the concrete plate a little bit (strong knife) for the thread.

8. Finally you can screw on the handle.

# Serving Trays



Material Used	Article Number	Quantity
Casting Form - Etagere Round, approx. Ø 130 mm, Ø 190 mm, Ø 250 mm, approx. 10 mm high, material required: approx. 1400 g jewellery-cement, material required individually: Ø 130 mm = approx. 250 g jewellery-cement, Ø 190 mm = approx. 450 g jewellery-cement, Ø 250 mm = approx. 700 g jewellery-cement	567928	1
Fine Concrete for Jewellery, 3000 g	608806	as required
Release Agent - Formestone 100 ml	480666	1
Stencil - Butterfly approx. 210 x 297 mm	469828	1
Stencil - Fantasy approx. 145 x 208 mm	501182	1
Marabu Stencil Adhesive Spray 36 ml	483642	1
Deco & Lifestyle Hobby Paint , light grey green, 230 ml	446295	1
Deco & Lifestyle Hobby Paint 230 ml, white	446228	1
Deco & Lifestyle Hobby Paint 230 ml, silver	446561	1
Deco & Lifestyle Hobby Paint 230 ml, soft black	446376	1
Deco & Lifestyle Hobby Paint, 230 ml, sand	608312	1
Metal - Decorative Ribbon, approx. 3 m x 30 mm, mint green	948513	1
Metal - Decorative Ribbon, approx. 3 m x 30 mm, grey	948524	1
Silver Wire, approx. Ø 0,40 mm, 40 m	249115	1
<b>Recommended Tools</b>		
BOSCH Glue Gun PKP-18E Electronic	301128	1
Glue Sticks, approx. Ø 11 x 200 mm, 25 pieces	301139	1
<b>Tools Required</b>		
Working pad, scissors, kitchen roll, vegetable oil, brush, measuring cup (or scales), mixing bowl, whisk (or spatula), winding wire, side cutter, bristle brush, water vessel, knife, hot glue gun and glue sticks		

Working instruction for casting concrete and decoration with stencils has been described in the instructions above.

*Have fun creating and enjoy!  
Your Opitec Creative Team!*