

# Ship ahoy - Wind Chime from Clay



<b>Used Material</b> (3 sails = approx. 1 kg modelling clay/material list for approx. 60 sailing boats)	<b>Article Number</b>	<b>Quantity</b>
School Clay - For modelling and pottery, 20 kg, white	519291	1
School Clay - For modelling and pottery, 20 kg, red	519305	alternatively
SIO-2 PLUS® Soft-Clay white, 1000 g	503088	alternatively
SIO-2 PLUS® Soft-Clay, 1000 g, terracotta	503077	alternatively
Botz Liquid Glaze, 200 ml, white glossy	546537	6
Botz Liquid Glaze, 200 ml, shell turquoise glossy	583308	6
Botz Liquid Glaze, 200 ml, black glossy	546906	6
Botz Liquid Glaze, 200 ml, silk glossy gold	519671	6
Marabu Acrylic Paint Decormatt, 50 ml, azure blue	486053	alternatively
Marabu Acrylic Paint Decormatt, 50 ml, yellow green	485873	alternatively
Marabu Acrylic Paint Decormatt, 50 ml, white	455713	alternatively
Marabu Acrylic Paint Decormatt, 50 ml, black	455724	alternatively
Marabu Acrylic Paint Decormatt, 50 ml, metallic gold	455746	alternatively
Binding Thread, ø 2 mm x 80 m, natural	537090	1
Bamboo Sticks, approx. ø 3 x 300 mm long, set of 100	608552	1
Bits of Root, assortment of root pieces, approx. 50 - 250 mm of length, brown, 1 kg	726771	6
Chime Set Alu Tubes, black, set of 3, ø 6 x 40/50/60 mm	802565	60
OPITEC All purpose glue, 250 ml, transparent	301678	1
<b>Recommended Tools</b>		
BOSCH Glue Gun PKP-18E Electronic	301128	1
Glue Sticks, approx. ø 11 x 200 mm, 25 pieces	301139	1
Creall® Modelling Tools Set, approx. 14 cm, 14 assorted designs	494933	1
Rolling Pin - Mini, wood, approx. ø 40 x 230 mm	427194	1
<b>Tools Required</b>		
Working pad, paper, pen, scissors, modelling roller, modelling tools (sharp knife), wood sticks, water vessel, bristle brush, kitchen roll, drilling machine with wood drill		



1 Roll out an approx. 7 mm thick slab of school clay (or air drying soft-clay).

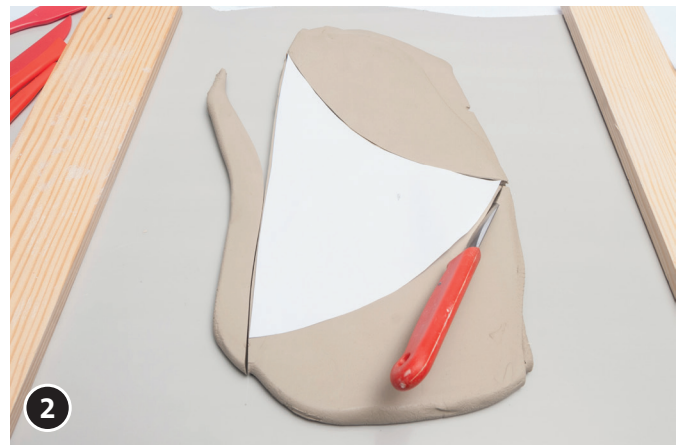

2 With pen and paper draw a model for the sail and cut it out. Place the model on the clay and cut out the sail from the slab. With a wooden stick bore a hole for the fastening at the lower edge of the sail. Bore another hole into the top of the sail for later hanging. Also with the wooden stick (or modelling tools) draw a decoration into the clay sail. Fire school clay in a kiln (according to product instructions). Or alternatively allow soft-clay to air dry for 1 - 2 days.



3 After firing and cooling down apply liquid glaze to the sail. The individual colours of the glazes can be mixed among each other. After application (according to product instructions) fire glaze again in kiln. Alternatively you also can use Marabu Acrylic Paints Decormatt. These don't need firing.



4 With the drilling machine bore a center hole into the root bit from above (for mounting the sail). On the lower part of the root bit bore three horizontal holes for mounting the three chime aluminum tubes.



Cut the wood stick to the desired length and connect with glue to sail and root bit.  
Cut three approx. 25 cm long strings of binding thread.  
Thread the string through the hole of a chime tube  
and a hole in the root bit and connect the two ends with a knot  
Mount all three chime tubes. Take care choosing the thread length for the chime tubes to be able to touch each other.  
For hanging cut an approx. 50 cm long piece of thread.  
Thread string through the upper bore hole of the sail and fix with a tight knot.

*Have fun creating and enjoy!  
Your Opitec Creative Team!*