

Embossed Mirror



Used Material

	Article No.	Qty
SIO-2 PLUS® soft clay, 1000 g, terracotta	503077	1
SIO-2 PLUS® soft clay, 1000 g, white	503088	1
Block-punch square spiral, 38 x 38 mm	510116	1
Block-punch Basket Weave, ca. 42 x 42 mm	510264	1
Block-punch Hex Honeycomb, about 60 x 60 mm	510378	1
Martha Stewart Premium acrylics Set, 10 x 59 ml, set of 10	574042	1
MDF roundel, approx. ø 450 mm	560111	1
Mirror approx. ø 180 mm	425723	1
Chalky finish - color 118 ml, stone gray	570303	1
Wooden discs ø ca. 10-30 mm, approx. 100 pieces	700634	1

Recommended Tools/Material

Sculpting - Roller, approx. ø 25 mm x 200 mm	807196	1
Cutter Set - Ring, approx. ø 29-112 mm, 14 pieces	541375	1
Templates - dwarfs, ca. ø 35 x 70 mm, 3 pieces	301860	1
3D silicone glue 80 ml	314798	1 or
BOSCH glue gun PKP 18E electronic	301128	1
Glue sticks approx. ø 11 x 200 mm, 25 pieces	301139	1

Needed Tools

Scissors, baking paper, modeling roller, round cutter, bristle brushes, water cups, silicone glue or hot glue gun with accessories



1 Roll an approximately 8 mm thick plate white and terracotta Sio-2 Plus® - soft clay.



2 Emboss different patterns with the block-stamps in the soft clay.



3 Cut out different sized circles with a ring-cutter (with embossed motive). Allow the soft-tone motives to dry for approx. 1-2 days.



4 Paint dried motives with the template dwarfs.

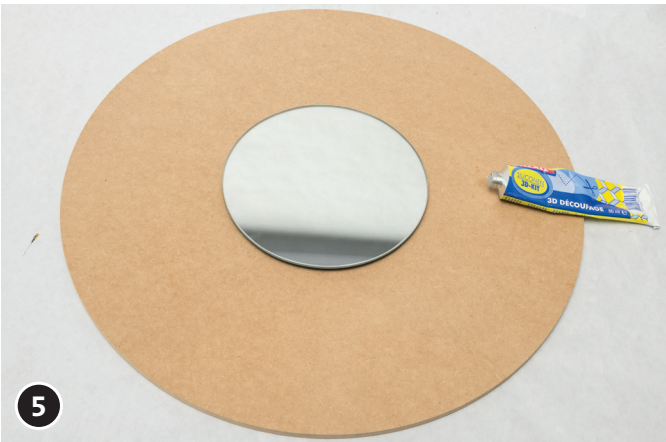

5 Fix the mirror centrally on the wooden ronde (silicone adhesive or hot glue).



6 Prime the ronde with stone gray chalky finish color. Allow the paint to dry.



Fix the wood pieces and soft-tone motives with silicone adhesive (or hot glue gun).

*Have Fun
Your Opitec Creative Team*