

Mokume Gane-Technik

Mokume Gane - Jewellery



Used materials:

| | Part no. | Qty |
|--|----------|-----|
| Metal Hanger – Oval, approx. 22 x 30 mm, silver, 2 pieces | 470773 | 1 |
| Metal-Hanger – Round, approx. ø 38 mm, silver | 474294 | 1 |
| Metal-Ring – Oval, with flat, can be adjusted, approx. 20 x 25 mm, silver | 486433 | 1 |
| Metal-Ring – Round, with flat, can be adjusted, approx. ø 24 mm, silver | 474319 | 1 |
| Sculpey® Bangle, metal, bendable, silver, size: approx. 180 x 20 mm | 442785 | 2 |
| Metal - Ring with round disc, can be adjusted, approx. ø 17 mm, disc: approx. ø 16 mm, | 575509 | 1 |
| Premo modelling material 57 g, silver | 419959 | 2 |
| Premo modelling material 57 g, olive green | 585539 | 2 |
| FIMO® soft modelling paste 57 g, sahara | 427149 | 2 |
| FIMO® soft modelling paste 57 g, chocolate | 495364 | 2 |
| FIMO® soft modelling paste 57 g, white | 495700 | 2 |
| FIMO® soft modelling paste 57 g, brilliant blue | | 2 |
| FIMO® soft modelling paste 57 g, cognac | 495962 | 2 |
| FIMO® soft modelling paste 57 g, caramel | 495375 | 2 |
| FIMO® soft modelling paste 57 g, pacific blue | | 2 |
| FIMO® soft modelling paste 57 g, aqua | 495744 | 2 |

| | | |
|--|--------|---|
| Sculpey® Design-Stamp, approx. 83 x 30 x 10 mm, set of 4 | 408510 | 1 |
| Sculpey® hollow beads former, 1 Metal-Form (approx. 210 x 118 x 10 mm) | 442730 | 1 |
| Headpins, approx. 45 mm long, 100 pieces, platinum 4 | | 1 |
| jewellery chain, approx. 500 x 12 mm, platinum | 548012 | 1 |
| jewellery chain, approx. 300 x 18 mm, platinum | 575532 | 1 |
| middle part, approx. ø 6 mm, 20 pieces, platinum | 575521 | 1 |
| panzer chain, platinum, approx. ø 4 mm, approx. 1 m long | 583803 | 2 |
| panzer chain, approx. ø 6 mm, approx. 1 m long, platinum | 722515 | 2 |
| Satin cord, 6 m, approx. ø 2 mm, light blue | 722526 | 1 |
| Satin cord, 6 m, approx. ø 2 mm, light brown | 567227 | 1 |
| Satin cord, 6 m, approx. ø 2 mm, light green | 558640 | 1 |
| | 558639 | |
| Required Tools: | | |
| | | 1 |
| Modelling-Roller, approx. ø 25 mm x 200 mm | 807196 | 1 |
| Staedtler - Fimo Clay Machine | 438197 | 1 |
| FIMO® Cutter – Set, approx. 110 - 150 x 20 mm, set of 4 | 527333 | 1 |
| Biscuit Cutter Set – Ring | 541375 | 1 |
| Garnier-Cutter–Set, approx. 7 - 40 mm, approx. 18 mm high, set of 42 | 474892 | 1 |
| Mosaic acrylic glue universal 80 ml, transparent | 539697 | |

Tools required:

Surface (paper, baking paper); measuring tape or ruler, modelling-roller, kneading machine, FIMO cutter-set, round cutter, pointed knife, Sculpey® Design-Stamp, flat bowl for water, scissor, round-nose pliers, flat-nose pliers, kitchen roll, side cutting pliers, Sculpey® Technique Design Blocks



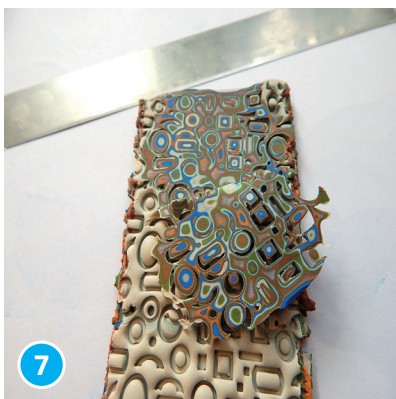
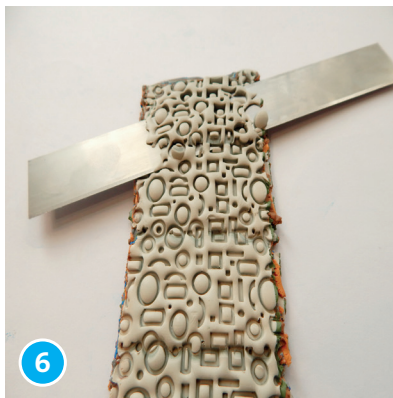
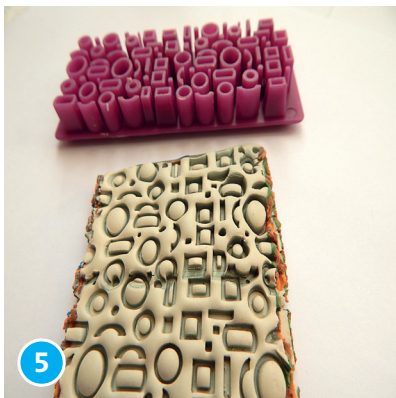
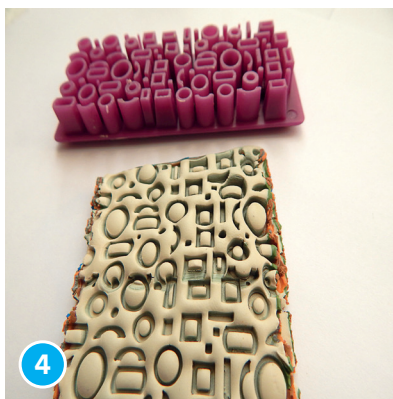

Instructions

1. Take a modelling paste. Separate a part of it and knead it hand warm. Roll the particular mass out to a approx. 2mm strong plate. Cut the coloured plate to a size of approx. 10 x 5 cm. Take 3-5 other modelling pastes and do the same.
2. Lay the plates on top of each other and press them together. (Bundle)
3. Spin the bundle through the biggest adjustment of the kneading machine. (the bundle gets longer). Separate the stripe in equal pieces and lay them on each other again. (arising thickness approx. 12 mm)
4. Dip the desired Sculpey® Design-Stamp into water. Press the stamp on the hole stripe for a number of times.
5. Be careful don't press to strong, so that one complete layer (includes all colours) keeps unaffected.
6. You peel a filmy layer of the modelling mass with the movable FIMO® Cutter-Knife. Now you see the arising pattern.
7. Roll out a modeling plate (thickness approx. 2mm), which you use as base. Therefore you can take modelling deposits or a new one coloured modelling paste.
8. Moreover lay the thin, patterned layers on top of the modelling plate.

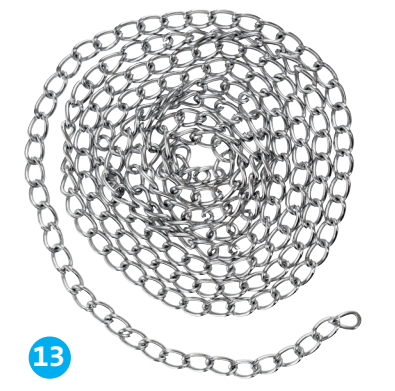
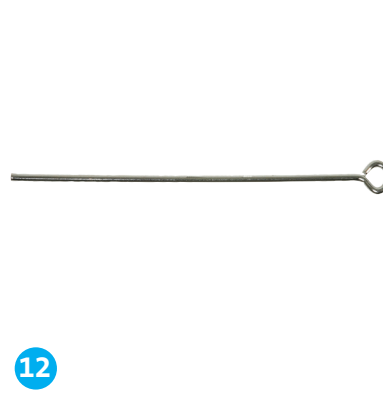
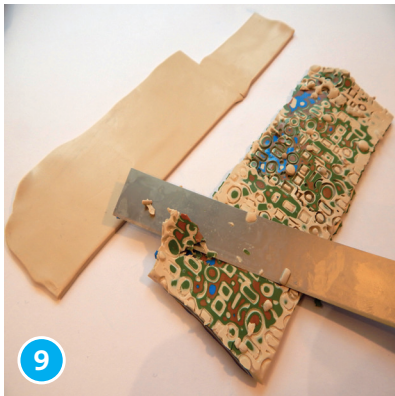

9. Now separate filmy layers again and again and lay them on the plate. In the end your plate should be occupied completely with patterned layers.

10. Press the films together with the modelling roller. Put the occupied plate in the kneading machine (biggest adjustment) and roll it out.

11. Take the Sculpey® hollow beads former. Separate two equal circles in favoured pearl size with the round cutter from the patterned plate. Lay down the circles on a suitable bulge of the pearl former. Harden the circles in the baking oven by 110° degrees for 30 minutes. Cool the curved discs down.

12. Lay a chain pin between both bowls. Fix both bowls (with chain pin) at the outer edge with glue, to create a hollow pearl.

13. Thread the desired chain or cord through the loop of the chain pin.

14. The chain get closed with a middle part and the cord ends get knotted.



Instructions

1. If you want to model rings or pendants, harden the modeled Mokume Gane circle (other shapes are possible) in the baking oven and connect the ring with the hardened circle. If you want to thread a cord into your pendant, you will thrill a small hole in the modeled shape before baking.
2. If you want to design an individual ring or a pendant by ornatng the small bowl, you will cut out the favoured shape of the modelling paste on basis of the opening. To thread a cord or a chain through your pendant, thrill a small hole in it before hardening. Now bake the shapes and press them into the bowls.

Producing a bangle



Instructions

1. The Instructions for the bangles are identically to the instructions for the hollow beads. So you can resume it for the bangles.

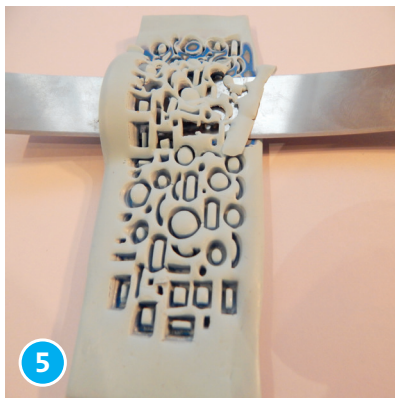
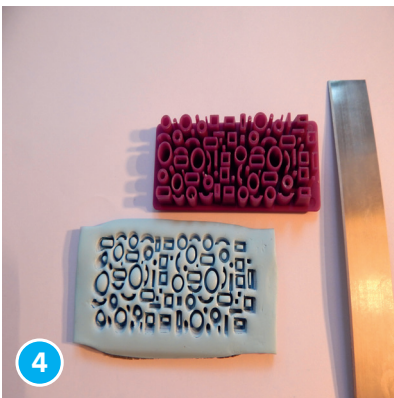
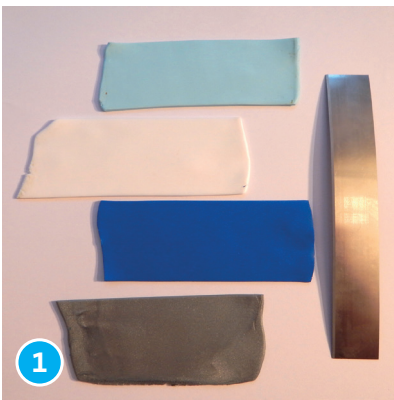

Mokume Gane - Eggs

| Used Materials | Article No. | Qty. |
|--|---------------|----------|
| Wooden eggs, Pack of 10 | 609064 | 1 |
| Wooden eggs, Pack of 10 | 609086 | 1 |
| Premo modelling material 57 g, silver | 419959 | 2 |
| Premo modelling material 57 g, olive green | 585539 | 2 |
| FIMO® soft modelling paste 57 g, sahara | 427149 | 2 |
| FIMO® soft modelling paste 57 g, chocolate | 495364 | 2 |
| FIMO® soft modelling paste 57 g, white | 495700 | 2 |
| FIMO® soft modelling paste 57 g, brilliant blue | 495962 | 2 |
| FIMO® soft modelling paste 57 g, cognac | 495375 | 2 |
| FIMO® soft modelling paste 57 g, caramel | 495331 | 2 |
| FIMO® soft modelling paste 57 g, pacific blue | 495744 | 2 |
| FIMO® soft modelling paste 57 g, aqua | 408510 | 2 |
| Sculpey® Design-Stamp, approx. 83 x 30 x 10 mm, set of 4 | 442730 | 1 |
| jewellery chain, approx. 500 x 12 mm, platinum | 548012 | 1 |
| Satin cord, 6 m, approx. ø 2 mm, light blue | 567227 | 1 |
| Satin cord, 6 m, approx. ø 2 mm, light brown | 558640 | 1 |
| Satin cord, 6 m, approx. ø 2 mm, light green | 558639 | 1 |

Recommended Tools:

| | | |
|--|--------|---|
| Modelling- Roller, approx. ø 25 mm x 200 mm | 807196 | 1 |
| Staedtler - Fimo Clay Machine, approx. 270 x 265 x 167 mm, roll width approx. 175 mm | 438197 | 1 |
| FIMO® Cutter – Set, approx. 110 - 150 x 20 mm, set of 4 | 527333 | 1 |
| Mosaic acrylic glue universal 80 ml, transparent | 539697 | 1 |

Required Tools:

Surface (paper, baking paper); measuring tape or ruler, modelling-roller, kneading machine, FIMO cutter-set, pointed knife, Sculpey® Design-Stamp, flat bowl for water, scissor, kitchen roll, Sculpey® Technique Design Blocks

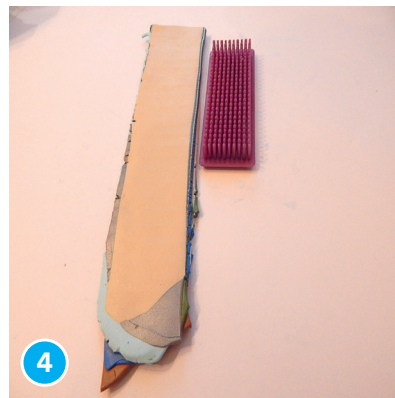

Illustrated Instructions

1. The Instructions for the eggs are identically to the instructions for the hollow beads. So you can resume it for the eggs.

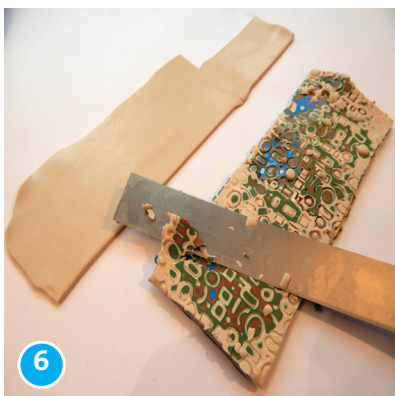



Mokume Gane - Lantern

| Used Materials | Article No. | Qty. |
|---|-------------|------|
| Glass-Set straight, set of 6 | 563980 | 1 |
| FIMO® effect bar 56 g, transparent | 496898 | 4 |
| FIMO® effect bar 56 g, transparent/nacre blue agate | 475614 | 3 |
| FIMO® effect bar 56 g, transparent/ nacre ice crystal | 475669 | 3 |
| FIMO® effect bar 56 g, transparent/ nacre jade | 475566 | 3 |
| FIMO® soft bar 56 g, pacific blue | 495744 | 1 |
| FIMO® soft bar 56 g, caramel | 495331 | 1 |
| Premo modelling material 57 g, olive green | 585539 | 1 |
| Sculpey® Technique Design Blocks, set of 4 | 442730 | 1 |

Recommended Tools:

| | | |
|--|--------|---|
| Modelling– Roller, approx. ø 25 mm x 200 mm | 807196 | 1 |
| Staedtler - Fimo Clay Machine, approx. 270 x 265 x 167 mm, roll width approx. 175 mm | 438197 | 1 |
| FIMO® Cutter – Set, approx. 110 - 150 x 20 mm, set of 4 | 527333 | 1 |

Required Tools:

Surface (paper, baking paper); measuring tape or ruler, modelling-roller, kneading machine, FIMO cutter-set, pointed knife, Sculpey® Design-Stamp, flat bowl for water, scissor, kitchen roll, Sculpey® Technique Design Blocks

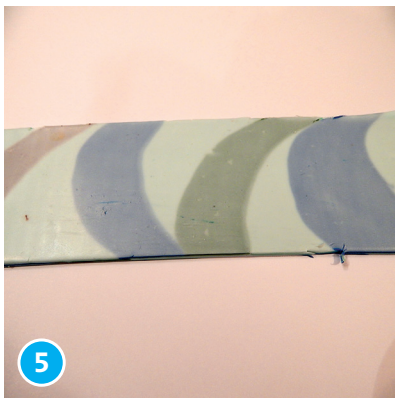
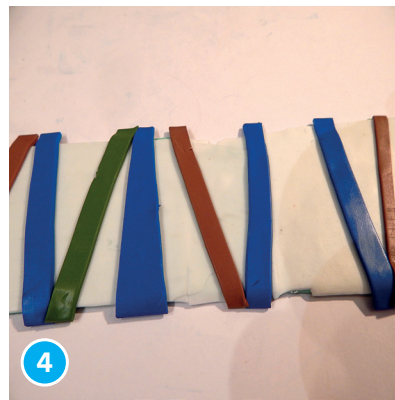
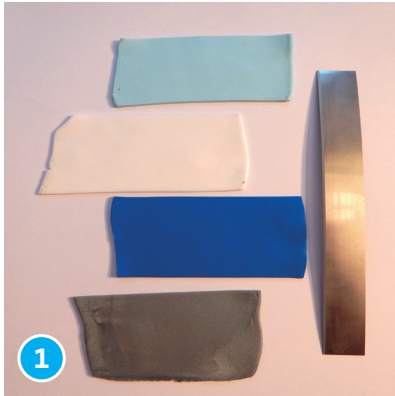

Anleitung:

1. Take the transparent modelling pastes (4 types). Separate a part of each and knead it hand warm. Roll each modelling mass out to a approx. 2mm strong plate. Cut the coloured plate to a size of approx. 10 x 5 cm.

2. Lay the plates on top of each other and press them together. (Bundle)

3. Spin the bundle through the biggest adjustment of the kneading machine. (the bundle gets longer). Separate the stripe in equal pieces and lay them on each other again. (arising thickness approx. 12 mm)

4. Take the modelling pastes pacific blue, caramel and olive green. Separate a part of each and knead it hand warm. Roll each modelling mass out to an approx. 2mm strong plate. Cut stripes of each plate and put them on the modelled plate.

5. Spin the occupied stripe through the kneading machine. Make sure that the resulting length corresponds to the circumference of the desired glass.

6. Dip the desired Sculpey® Design-Stamp into water. Press the stamp on the stripe for a number of times, so that the hole stripe is decorated. Be careful don't press to strong, so that one complete layer (includes all colours) keeps unaffected.

7. You peel a filmy layer of the modelling mass with the movable FIMO® Cutter-Knife. Repeat this as long as you get the desired pattern. Next, lay the strips on the glass. Disconnect excessive modelling mass. Harden the modelled glass in the baking oven by 110 ° C for 30 minutes. Cool the glass down.